

MS5525WM

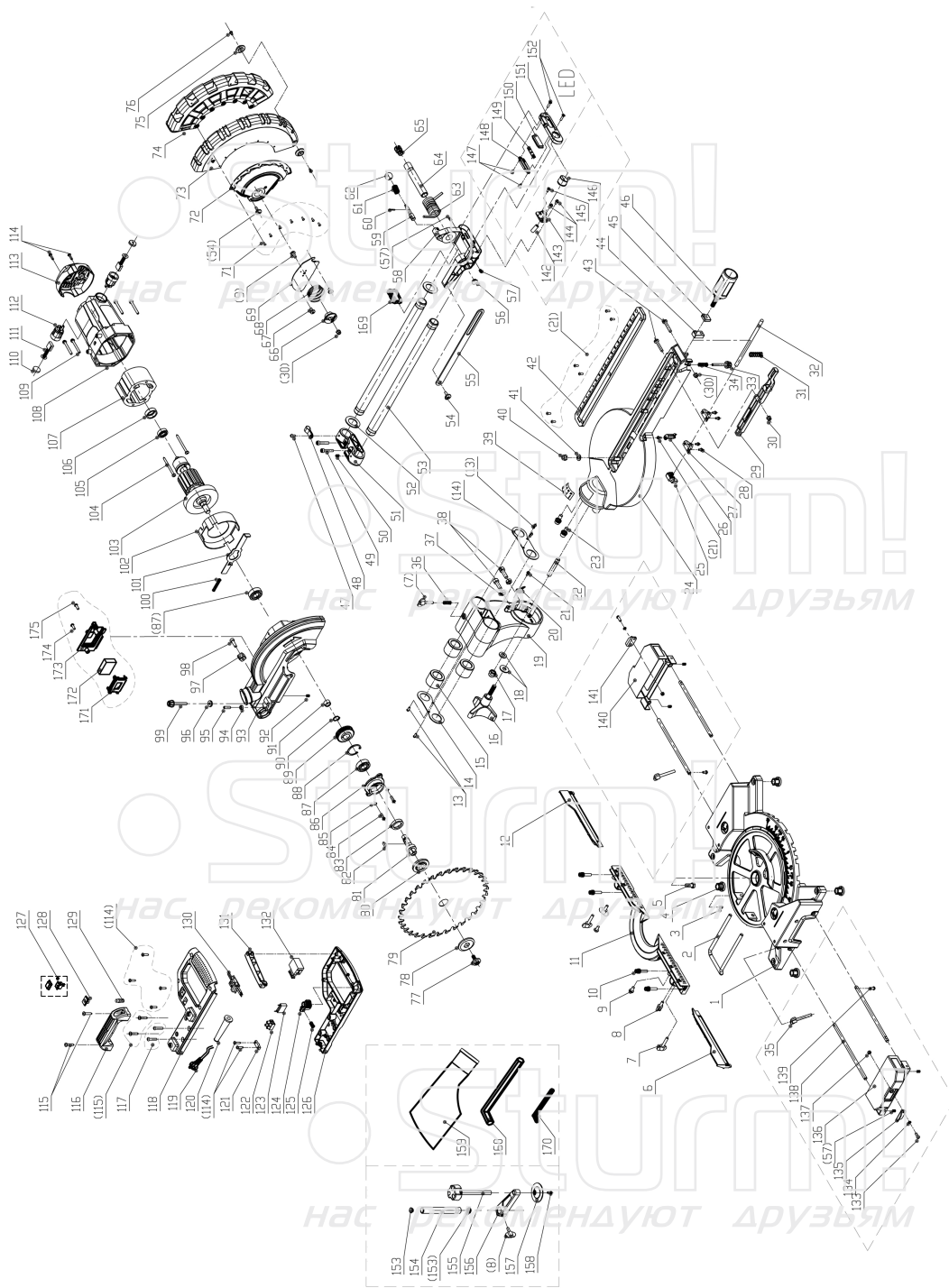

NO.	DESCRIPTION	NO.	DESCRIPTION	NO.	DESCRIPTION
1	Base	58	Support	116	Cross Groove Pan Head Self Tapping Screw
2	Rear Support Frame	59	Lock Pin	117	Handle
3	Hexagon Socket Set Screw With Flat End	60	Spring Pin	118	Above Handle
4	Plum Rubber Foot	61	Lock Pin Spring	119	Cable
5	Hexagon Head Bolt	62	Ball Nut	120	Cable Jacket
6	Left Active Rest	63	Big Torsional Spring	121	Line Pressing Board
7	Butterfly Screws	64	The Connecting Shaft	122	Wiring Row
8	Butterfly Screws	65	Clamp Wire Plug	123	Capacitance
9	Pan Head Screw With Cross Groove	66	Transparent Hood Clamp	124	Switch Self-locking Button
10	Hexagon Socket Cap Screw	67	Pan Head Screw With Cross Groove	125	Button Spring
11	Shelf	68	Large Transparent Housing Spring	126	Bottom Handle
12	Right Active Rest	69	Large Hood	127	Two speed Switch
13	Pan Head Screw With Cross Groove	71	Rivet	128	Ejector Seat
14	Straight Bearing End Cover	72	Transparent Cover Guard	129	Jector
15	Linear Bearing	73	Transparent Cover	130	Circuit Board
16	Angle Lock Handwheel	74	Transparent Cover Coat	131	Switch Trigger
17	Type 2 Non-metallic Hexagon Lock Nut	75	Pulley	132	Switch
18	Gasket	76	Cross Groove Pan Head With Pad Tapping Screw	133	Pan Head Screw With Cross Groove
19	Connecting Base	77	Saw Blade Fixing Screw	134	Spring Washers
20	Oblique Pointer	78	Outer Pressing Plate	135	Left Wing Flap
21	Cross Recess Pan Head Screw	79	Blade	136	Left Wing Flap
22	Hexagon Socket Set Screw With Flat End	80	Inner Pressing Plate	137	Type 2 Non-metallic Hexagon Lock Nut
23	Hexagon Socket Cap Screws	81	Output Shaft	138	Extension Rod
24	Disk	82	Woodruff Key	139	Pan Head Screw With Cross Groove
25	Clutch Block	83	Skeleton Oil Seal	140	Right Wing
26	Disk Pointer	84	Countersunk Head Screw With Cross Recess	141	Right Wing Flap
27	Disc Locking Rod Fixing Seat	85	Cup Mat	142	Laser Head
28	Cross Recess Pan Head Screw	86	Front Cover	143	Laser Bench
29	Plastic Retaining Rod	87	Bearing	144	Pan Head Screw With Cross Groove
30	Type 2 Non-metallic Hexagon Lock Nut	88	Elastic Retainer For Holes	145	Cross Countersunk Head Tapping Screw
31	Fixed Bar Spring	89	Big Gear Wheel	146	Laser Transparent Cover
32	Disc Locking Lever	90	Elastic Retaining Ring For Shaft	147	Self Tapping Screw With Cross Grooves
33	Lock Knob	91	Needle Roller Bearing	148	Led Pressing Plate
34	Switch Trigger Spring	92	Hexagon Socket Set Screw With Flat End	149	Led Light
35	Butterfly Screws	93	Head Housing	150	Led Transparency
36	Pull Rod Locks The Spring	94	Nut	151	Led Light Bench
37	Nut	95	Hexagon Socket Set Screw With Flat End	152	Countersunk Head Screw With Cross Recess
38	Hexagon Socket Cap Screw	96	Knurled Thin Nut	153	Fixed Rod Cover
39	Connecting Base Label	97	Collision Block	154	Fixed Rod
40	Type 2 Non-metallic Hexagon Lock Nut	98	Hexagon Socket Cap Screw	155	Handwheel
41	Flat Gasket	99	Lock Knob	156	Clamp Block
42	Incision	100	Shaft Lock Spring	157	Embedded Iron
43	Pan Head Screw With Cross Groove	101	Shaft Lock Plate	158	Non-standard Screws
44	Locking Top Piece	102	Wind Circle	159	Bag Spring
45	Side Handle Support Block	103	Rotor	160	Hexagon Wrench
46	90° Side Handle	104	Cross Groove Pan Head Self Tapping Screw	170	Hexagon Wrench
47	Pan Head Screw With Cross Groove	105	Bearing	171	Governor Mounting Seat
48	Line Buckle	106	Bearing Housing	172	Speed Control Module
49	Hexagon Socket Cap Screw	107	Stator	173	Governor Cover Plate
50	Hexagon Socket Set Screw With Flat End	108	Machine Housing	174	Large Pan Head Screw With Cross Groove
51	Rod Rear Cover	109	Pan Head Screw With Cross Groove	175	Large Pan Head Screw With Cross Groove
52	Rod Gasket	110	Brush Cover		
53	Rod	111	Electric Brush		
54	Large Pan Head Screw With Cross Groove	112	Brush Handle		
55	Connecting Rod	113	Machine Rear Cover		
56	The Connecting Shaft Cover	114	Cross Groove Pan Head Self Tapping Screw		
57	Hexagon Socket Set Screw With Flat End	115	Cross Groove Pan Head Self Tapping Screw		